

- Introductory/ Lobby concept:**
To create a three dimensional portal/ waharoa: an acclimatisation area that invites, involves and introduces the visitor to the exhibition.
The aesthetic will be evocative of the 1970s via
- colour palette and treatment
 - graphic design
 - furniture
- Content:**
- Exhibition title and tagline
 - Bi-lingual Introductory text
 - Wall mounted cases displaying objects (props) representative of the exhibition.
 - Seated area for the viewing of photo albums & listening to ambient music

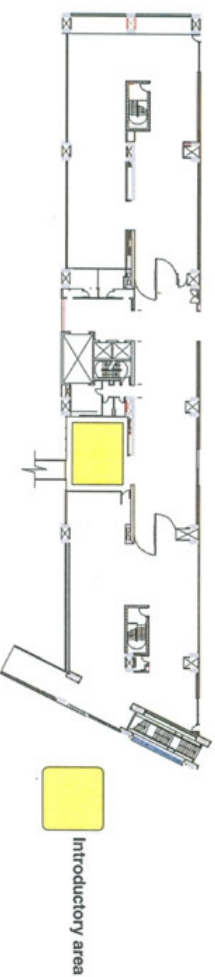

 <p>Project Office, 2nd Fl, Te Papa, Cable Street Wellington, NZ 7000 (tel) +64-4-381 7000 (fax) +64-4-381 7070</p>		<p>DRAWING TITLE INTRODUCTORY/ LOBBY AREA</p>	
<p>PROJECT TITLE LEVEL 5 BOULEVARD OUT ON THE STREET</p>		<p>Check all dimensions on site before commencing. Work to figured dimensions and report any discrepancies to the Contract Manager. This drawing is a copy right and must not be reproduced, copied or used without the written consent of the Museum of New Zealand</p>	
<p>DRAWING STATUS DATE ISSUED</p>		<p>ATTACHED CAD REFERENCE FILES</p>	
<p>ex(OUT)1200 REVISION A 21/4/04</p>		<p>Doc. coordinator LTF Scale: 1:100 Date: 17/3/04 Checked by: MGNZ App. by: MGNZ Date:</p>	

Figure 10: Introductory area *Out on the Street*